

H-13 "THROUGH-HARDENED" HOTWORK EJECTOR PINS

TIGHTEST TOLERANCE IN THE INDUSTRY (.0003")

MATERIAL : H-13 HOTWORK DIE STEEL

CORE: THROUGH-HARDENED TO 50-55 RC

SURFACE: ION NITRIDED TO 65-74 RC

HEADS: ANNEALED

TOLERANCES			
P	H	T	L
-.0005"	+.000"	+.000"	+.375"
-.0008"	-.010"	-.002"	-.000"

HOW TO ORDER: EXAMPLES			
Qty.	Cat No.	(IF .005" O.S.)	Length
24	RHX-7-1/2	+.005	L-10
48	RHX-3-2		L-6

SHOULDER STYLE

FRACTIONAL AND .005" OVERSIZED DIAMETERS

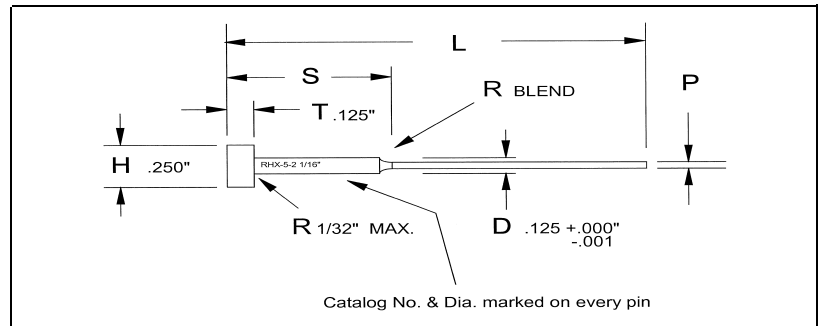

CATALOG NUMBER	P		S	NET PRICE EACH PER QUANTITY (US \$)					PKG. QTY.	
	PIN DIA.			SHOULDER LENGTH	L-6"	L-10"		L-14"		
	NOMINAL DIA.	DECIMAL EQUIV.			STANDARD DIA.	STANDARD DIA.	+.005" OVERSIZED DIA.	STANDARD DIA.		+.005" OVERSIZED DIA.
RHX-2-1/2	1/32	0.03125	1/2"	7.35	Q	Q	Q	Q	12	
RHX-2-2			2"	7.25	Q	Q	Q	Q		
RHX-2-3			3"	Q	9.15	10.10	Q	Q		
RHX-2-4			4"	Q	9.15	10.10	Q	Q		
RHX-3-1/2	3/64	0.0469	1/2"	4.25	Q	Q	Q	Q		
RHX-3-2			2"	4.05	4.65	5.40	Q	Q		
RHX-3-3			3"	Q	5.10	6.15	Q	Q		
RHX-3-4			4"	Q	5.70	6.15	Q	Q		
RHX-5-1/2	1/16	0.0625	1/2"	3.95	4.90	5.60	Q	Q		
RHX-5-2			2"	3.85	4.50	5.40	6.20	7.15		
RHX-5-3			3"	Q	4.75	5.85	Q	Q		
RHX-5-4			4"	Q	5.30	6.45	Q	Q		
RHX-6-1/2	5/64	0.0781	1/2"	3.95	4.90	5.70	Q	Q		
RHX-6-2			2"	3.85	4.50	5.10	6.20	7.15		
RHX-6-3			3"	Q	4.75	5.85	Q	Q		
RHX-6-4			4"	Q	5.30	6.45	Q	Q		
RHX-7-1/2	3/32	0.0938	1/2"	3.60	4.55	5.10	Q	Q		
RHX-7-2			2"	3.40	4.30	4.90	5.80	6.75		
RHX-7-3			3"	Q	4.30	5.35	Q	Q		
RHX-7-4			4"	Q	4.75	5.85	Q	Q		
RHX-8-1/2	7/64	0.1094	1/2"	3.60	4.55	5.10	Q	Q		
RHX-8-2			2"	3.40	4.05	4.60	5.80	6.75		
RHX-8-3			3"	Q	4.30	5.35	Q	Q		
RHX-8-4			4"	Q	4.75	5.85	Q	Q		

Q = Price Per Quotation

Please see PAGE 1 for a complete list of modifications that are available for any of the ROYAL Family of Pins and Punches